

*Mike*  
**Dobson**



**4 Glebelands Close**

Garforth, Leeds, LS25 1HY

**£220,000**



## 4 Glebelands Close

A four bedroom semi-detached dormer bungalow, situated within a popular cul-de-sac location, close to local shops, schools and public transport links as well as having easy access to the A1/M1 motorway. The accommodation briefly comprises entrance porch, dining kitchen, lounge, two bedrooms and bathroom/WC to the ground floor, with two further bedrooms to the first floor. In addition, the property has gas central heating, PVCu double glazing, PVCu double glazed conservatory, fitted kitchen with four ring gas hob and built in electric oven, fitted wardrobes to the main bedroom, three piece bathroom suite with corner bath with electric shower over, fitted vanity display with cupboards, wash basin and low flush WC. Outside, to the front of the property a driveway provides off road parking and there is a lawned garden. To the rear is a paved seating area and lawn. The property does require internal updating and is reflected in the price . An early viewing is recommended.



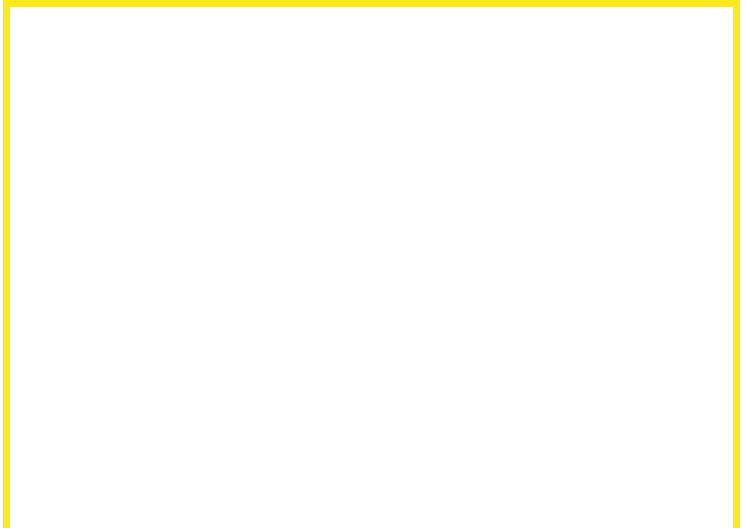

Floor Plan

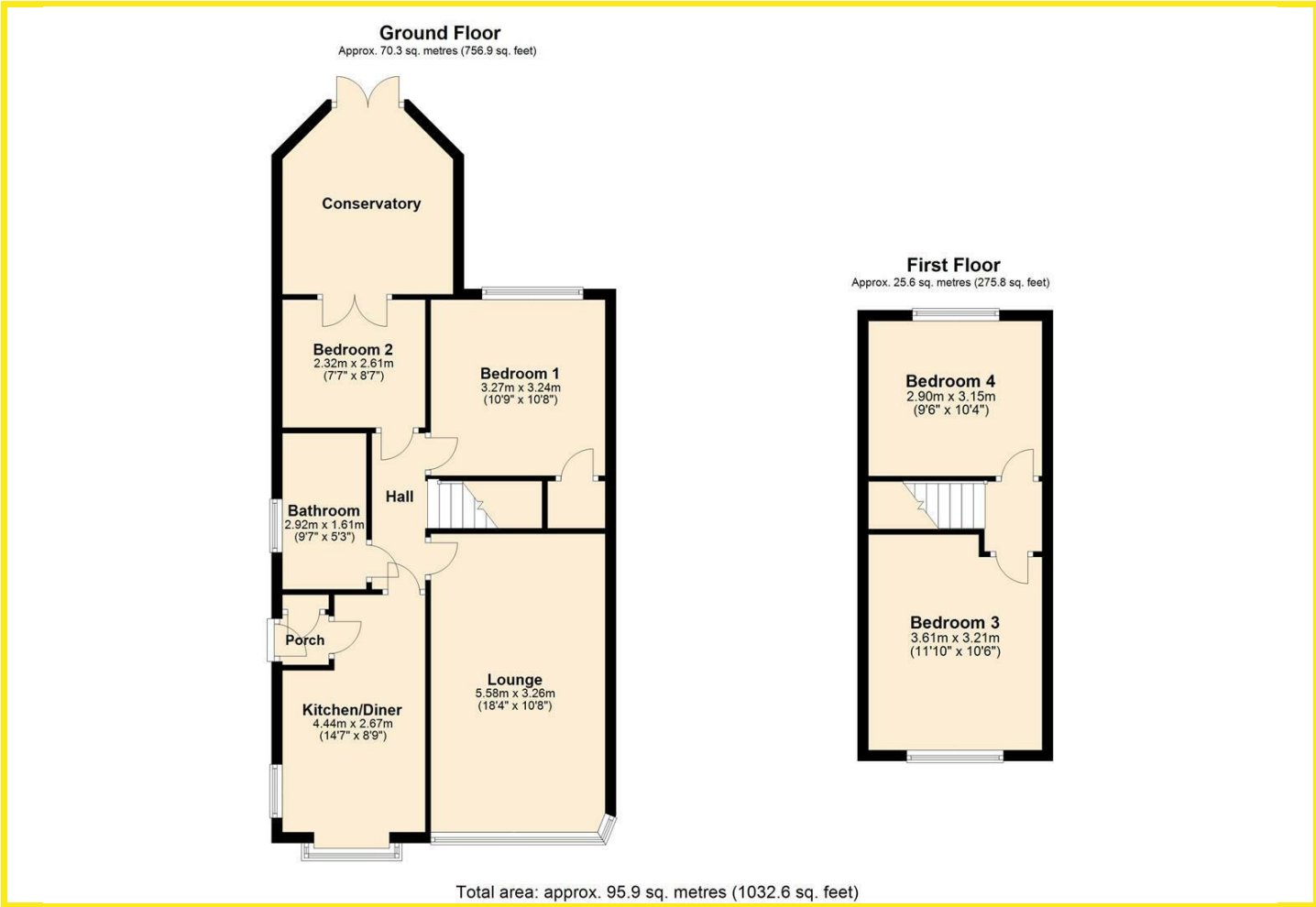

Area Map

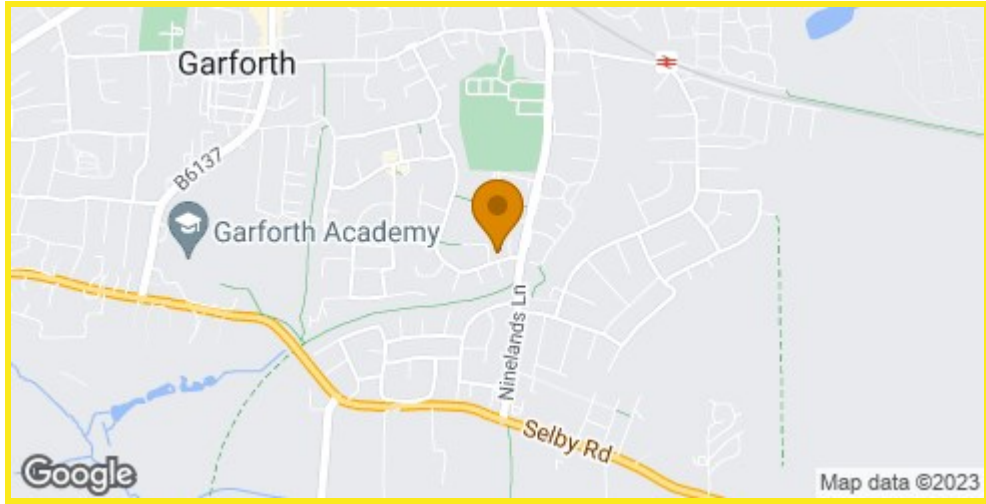

Energy Efficiency Graph

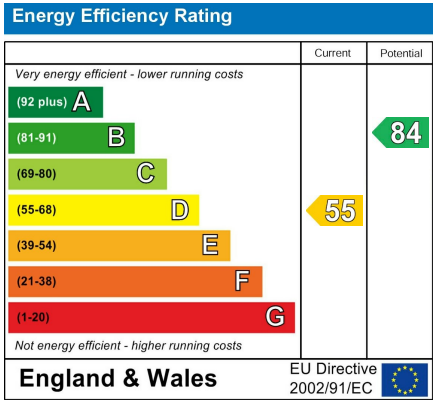

Directions

From the A63 Leeds/Selby Road turn on to Ninelands Lane and proceed ahead. Take the 3rd turn left onto Derwent Avenue and then Glebelands Close is the 2nd right . Alternatively from our Garforth Office proceed along Main Street and take the 2nd left onto Church Lane, continue along to the 'T' junction and then turn right on to Ninelands Lane. Take the 2nd right on to Derwent Avenue and then 2nd right on to Glebelands Close where the property can found on the right hand side.

These particulars, whilst believed to be accurate are set out as a general outline only for guidance and do not constitute any part of an offer or contract. Intending purchasers should not rely on them as statements of representation of fact, but must satisfy themselves by inspection or otherwise as to their accuracy. No person in this firms employment has the authority to make or give any representation or warranty in respect of the property.